

# USER MANUAL

## FILTER CRUSHER SERIES



**UFC550C**



**UFC850C**

**UNI-RAM CORPORATION • ONTARIO • CANADA**

**CONTENTS**

INTRODUCTION ..... 3

CAUTIONS AND WARNINGS ..... 3

SPECIFICATIONS ..... 3

PREPARATION AND SETUP ..... 4

INSTALLATION / MOUNTING TO FLOOR..... 4

OPERATION..... 4

MAINTENANCE ..... 5

TROUBLESHOOTING DOOR SAFETY SWITCH ..... 5

REPLACEMENT PARTS LIST ..... 6

FLOW DIAGRAM ..... 7

WARRANTY ..... 8

## INTRODUCTION

Uni-ram holds many patents on designs used in its innovative products. Every machine is tested for compliance with Quality Assurance standards. Follow the instructions on preparation, use and operation to operate this machine safely and effectively. Ensure that this manual is readily available to the operator at all times. If you have any questions about the operation of this machine, contact:

North America:  
Uni-ram Technical Service  
1-800-417- 9133  
Other Continents:  
Contact Your Supplier

## CAUTIONS AND WARNINGS

- This is a very heavy piece of equipment and must be handled with care to avoid accident or injury. All possible precautions must be exercised so that the unit does not fall, tip or adversely move to ensure maximum safety during transportation, unpacking, installation, operation and service. Bolt unit to the floor.
- Maximum input air pressure is 120 PSI (8.5 kg/cm<sup>2</sup>).
- Do not move the control lever, when the door is open.
- This equipment is intended for use on oil filters.
- During operation the Control Lever is set to the “CRUSH” position. When the unit is not in use, keep the control lever at the “OPEN” position. This will prevent unintended movement of the Crushing Plate.  
**DO NOT LEAVE THE CONTROL LEVER PART WAY BETWEEN THE TWO POSITIONS.**
- Disconnect the air supply before performing any repairs or servicing the unit.

## SPECIFICATIONS

MODEL	UFC550C	UFC850C
ITEMS CRUSHED	FILTERS AND CANS	FILTERS AND CANS
MAX SIZE OF ITEM (DIA X HEIGHT)	9.8 X 8.5”	12.6 X 16.5”
AIR CYLINDER SIZE	9.84”	12.6”
PISTON STROKE	7.9”	15.7”
CRUSHING FORCE (TONS AT 120 PSI)	4	7
SHIPPING DIMENSIONS (WDH)	17 X 15 X 39”	29 X 23 X 61”
WEIGHT (LB / KG)	350 / 160	770 / 350

**PREPARATION AND SETUP:****UNPACKING**

- Carefully inspect the shipping carton for any sign of transport damage. Damage to the carton often indicates transport damage to the equipment inside.
- Carefully remove the shipping carton, the pallet, and other packaging material from the equipment.
- Check the equipment. Report any transport damage to the carrier without delay to initiate claim procedures. Uni-Ram Corporation is not responsible for damage to equipment after it leaves our warehouse.
- This manual is a very important document. Carefully read this manual before operating this equipment. Keep this manual close at hand so that it is readily available as required.
- A label complying with all applicable standards is permanently fixed to the back of this equipment. Vital information such as the serial number, & model number, are clearly marked on the label and will be needed in the event of a service call.
- Make sure that all markings and labels are clearly legible.

**CAUTION:** *This is a very heavy piece of equipment and must be handled with care to avoid accident or injury. All possible precautions must be exercised so that the unit does not fall, tip or adversely move to ensure maximum safety during transportation, unpacking, installation, operation and services. **Bolt unit to the floor.***

**INSTALLATION / MOUNTING TO FLOOR**

- Place the unit in a suitable location, making sure that there is enough space for a pail to receive the crushed filters. On the left side of the unit, allow space for placing a pail to receive the waste oil.
- Bolt the unit to a solid floor made of cement, cement block or solid masonry
- Use 4 holes 5/8" diameter by 2" deep. Use anchors, bolts and washers (not supplied).
- Connect the air supply to the Air Inlet Fitting (1/4" Female NPT threads).

**CAUTION:** *Maximum input air pressure is 120 PSI (8.5 kg/cm<sup>2</sup>).*

- For receiving the waste oil drained from the crushed oil filters, place an empty pail on the left side of the unit.
- Insert the Oil Drain Hose into the pail.

**OPERATION**

Wear protective clothing in accordance with local safety and environmental regulations. Use face goggles and gloves as a minimum.

**CAUTION:**

- Make sure the control lever of the valve is in "OPEN" position
- Lift the safety door upward while pulling out and holding the door catch rod. Release the catch so that the door is held in place by the ledge at the top of the crushing chamber.
- Place one oil filter in the center of the crushing chamber.

**Note:** Make sure the oil filter is placed open end down and the filter sits evenly on the crusher plate.

- Close the safety door and rotate the control lever to the “CRUSH” position. The door will be locked and the crushing plate will start to move up. Crushing will be complete after 5-20 seconds depending on the size, construction and strength of the filter .
- Rotate the control lever to the “OPEN” position. The crushing plate will start to move down. As soon as the crushing plate reaches the bottom position, the door will be unlocked.
- Lift the door up and lock it in place, as described earlier, then remove the crushed oil filter. The machine is ready for the next cycle.

**CAUTION:** *This equipment is intended for oil filters. When the unit is not in use, keep the control lever at the “OPEN” position. This will prevent unintended movement of the Crushing Plate. DO NOT LEAVE THE CONTROL LEVER PART WAY BETWEEN THE TWO POSITIONS.*

## MAINTENANCE

- The mounting bolts should be checked periodically for tightness to ensure that the unit is secure.
- Check the waste oil pail periodically and empty the pail as required.
- Check the crushed filter pail periodically and empty the pail as required.

**CAUTION:** *Disconnect the air supply before performing any repairs or servicing the unit.*

## TROUBLESHOOTING DOOR SAFETY SWITCH

**The door safety switch for the UFC550C is different than the door safety switch for the UFC850C.**

### TROUBLE SHOOTING DOOR SAFETY SWITCH FOR THE UFC550C

A Door Safety Switch prevents the door of the Crushing Chamber from being opened until the Crushing Plate is all the way down. If the door does not open when the Crushing Plate is in the bottom (starting) position there are two possible solutions.

1. The switch is defective and must be replaced. The part number is 115-310F.
2. The switch can be adjusted by raising or lowering the adjustment screw (see picture) to ensure that air flows out of the switch back to the Control Box. To detect if air is flowing out of the switch, disconnect the air line as shown and check for air coming out of the switch. Adjust the screw until the air flow is detected.

## DOOR SAFETY SWITCH FOR UFC550C

**NOTE:**  
THE METAL COVER AT BACK OF UNIT (NOT SHOWN) MUST BE REMOVED BEFORE WORKING WITH THE DOOR SAFETY SWITCH

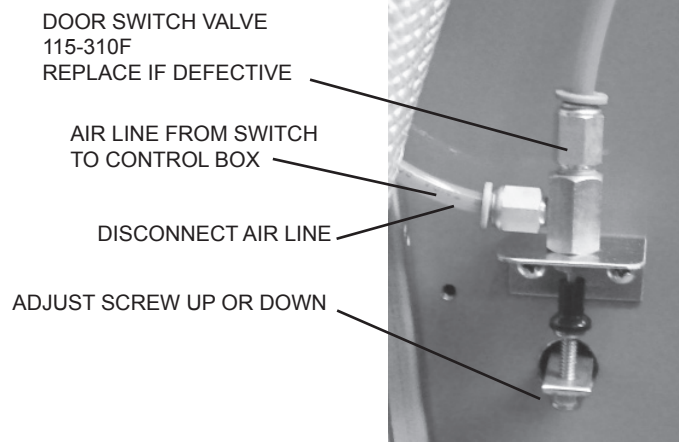

**TROUBLE SHOOTING DOOR SAFETY SWITCH FOR THE UFC850C**

A Door Safety Switch prevents the door of the Crushing Chamber from being opened until the Crushing Plate is all the way down. If the door does not open when the Crushing Plate is in the bottom (starting) position the door safety switch is defective and must be replaced. The part number is 115-310F.

NOTE:  
THE METAL COVER AT BACK  
OF THE UNIT , SHOWN BELOW,  
MUST BE REMOVED BEFORE  
WORKING ON THE DOOR  
SAFETY SWITCH



Cover in Place

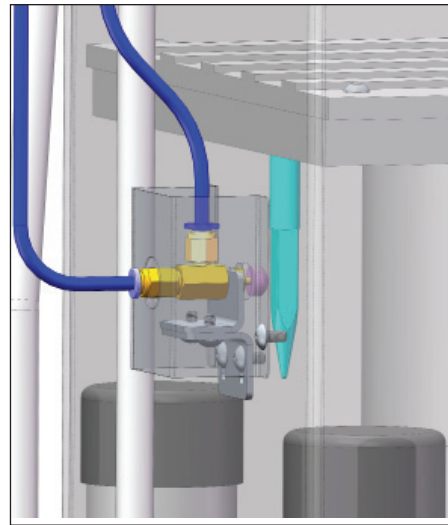

Cover in Place

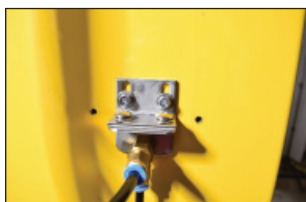

Cover Removed

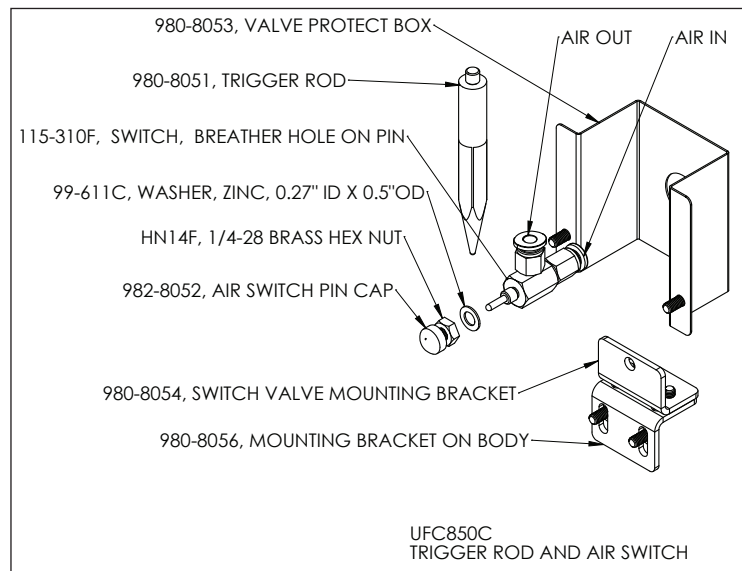

Parts with Cover Removed

### FLOW DIAGRAM

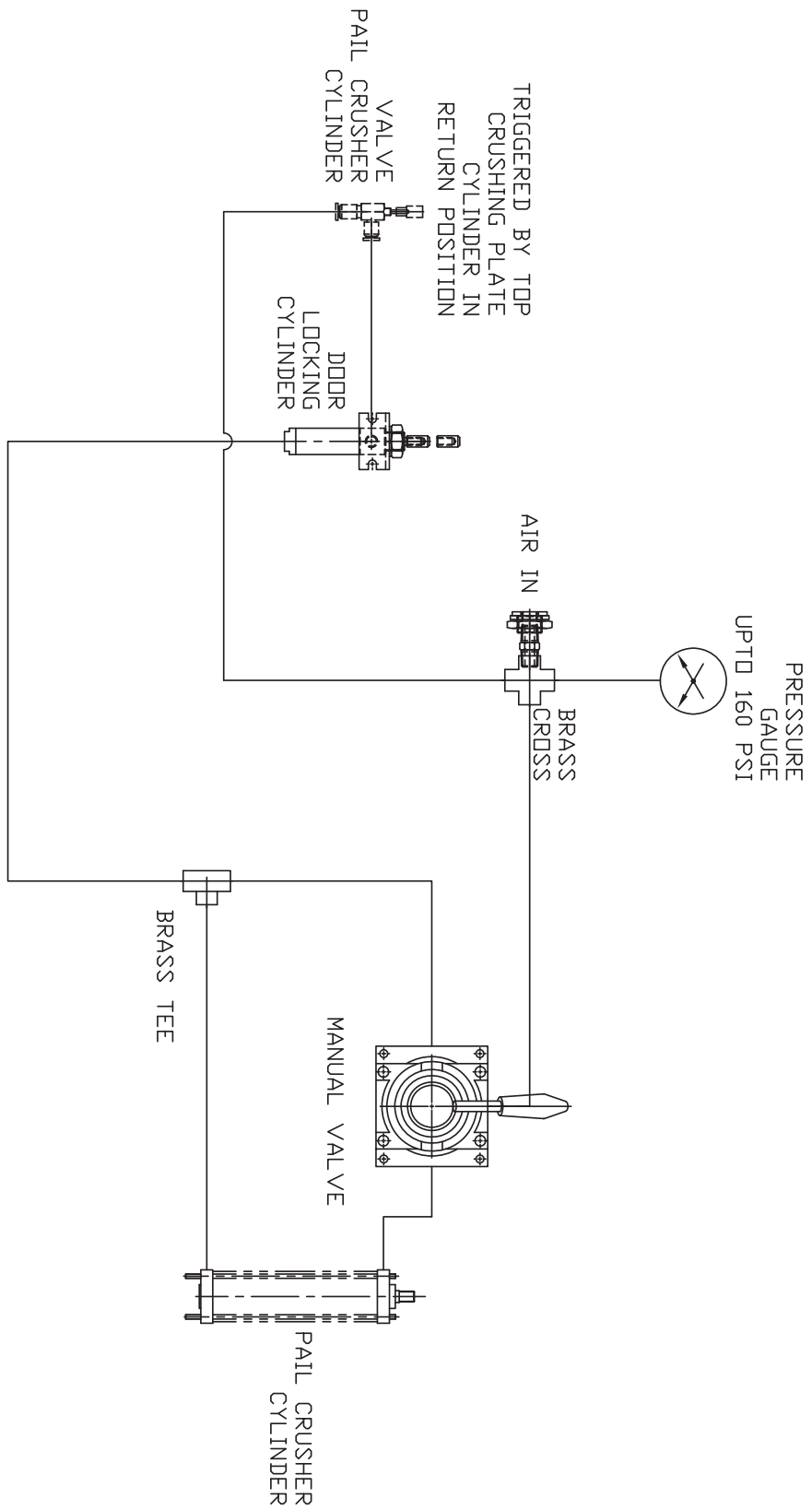

### REPLACEMENT PARTS

DESCRIPTION	PART NO.
WASTE OIL DRAIN TUBE	PVT32X158 (1.5 FT)
CONTROL BOX	982-1160A
MOISTURE FILTER FOR AIRLINE	975-7220F
DOOR SAFETY SWITCH	115-310F





### **Full Product Warranty**

These Uni-ram products have been engineered and manufactured to high performance standards. Each unit has been subjected to detailed factory testing before shipment.

This product comes with a one-year full warranty from the date of purchase. Uni-ram Corporation reserves the right to repair or replace the unit, free of charge, to the original purchaser if a part is found to be defective in material or workmanship as determined by factory service personnel. The items listed below under "Conditions of Warranty" as consumables are not covered.

Uni-ram reserves the right to direct the customer to ship the unit collect to the Uni-ram factory or to an approved Service Center for repair using the Uni-ram Return Goods Procedure or to repair the unit on-site. To prevent damage in transport, the purchaser must ship the unit in the original packaging or use alternate adequate packaging. All units must be shipped clean and free of liquids.

#### Conditions of Warranty:

As Uni-ram Corporation has no control over the working conditions or circumstances under which the purchaser stores, handles or uses the product, Uni-ram makes no warranty or claim, either expressed or implied with respect to this product's fitness for any purpose or the result to be obtained from its use. This condition applies to the sale of all products and no representative or distributor of Uni-ram Corporation has the authority to waive or change these conditions.

This warranty applies only to the original purchaser and does not apply if the unit has been misused, overloaded, neglected, altered or used for any purpose other than those specified in the operating and installation instructions. Deterioration due to normal wear is not covered by this warranty. Damage due to accident, transportation, fire, floods or acts of God is also not covered. Units whose serial numbers have been altered or removed are not covered. The warranty is invalid if unauthorized abrasives are used in this unit. Unauthorized attempts at self-repair or alterations by the owner also invalidate this warranty. Interior or exterior finishes are not covered by this warranty.

Consumable Items are not covered by this warranty.

This warranty replaces all other warranties expressed or implied by statute or otherwise.

To make a claim, call Uni-ram Service at 1-800-417-9133 and quote the serial number of the unit.